

## Bit for square-head screws

**Article No.:** 911.3001  
**EAN:** 4042146111710  
**RRP:** €2.64 \*

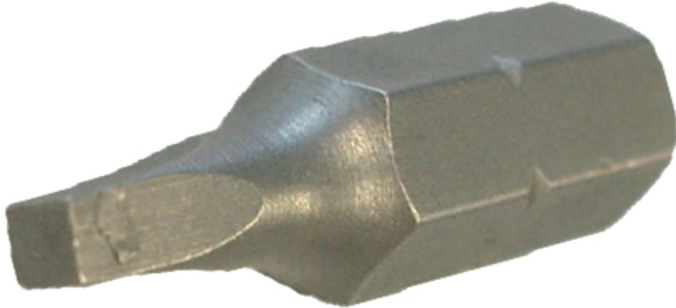

### Description

- internal square
- with external hexagon drive according to DIN 3126 / ISO 1173 Form - C 6.35
- can be used by hand or with an electric screwdriver
- ideally suited for fittings in trade and industry
- reinforced execution
- nickel plated
- special tool steel

### Properties

<b>Drive in imperial:</b>	1/4
<b>Form:</b>	form C 6.35
<b>Material1:</b>	S2 special steel
<b>Packaging contents:</b>	1
<b>Packaging height, mm:</b>	2
<b>Packaging length, mm:</b>	15
<b>Packaging width, mm:</b>	7
<b>Profile size security bits:</b>	#0
<b>Total length L in mm:</b>	25.0
<b>Weight [g]:</b>	5
<b>profile1:</b>	4 point

